

|             |                               |
|-------------|-------------------------------|
| Notes:      |                               |
| M8 nut      | M8 hex nut, steel, tin plated |
| Molded part | Insulation part, PPS, black   |

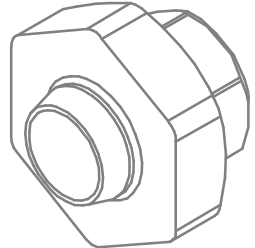

CF series cubeOTO fuse reference table:

| Rating<br>[ A ] | Volt<br>[ V ] | iMaXX Reference |
|-----------------|---------------|-----------------|
| 50              | 58            | CF050           |
| 75              | 58            | CF075           |
| 100             | 58            | CF100           |
| 125             | 58            | CF125           |
| 150             | 58            | CF150           |
| 175             | 58            | CF175           |
| 200             | 58            | CF200           |
| 250             | 58            | CF250           |
| 300             | 58            | CF300           |

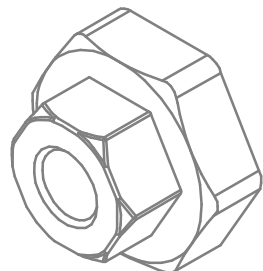

|           |      |  |            |              |                |  |
|-----------|------|--|------------|--------------|----------------|--|
| Revisions |      |  | Drawn      | Date         | Appr.          |  |
| Date      | Type |  | Checked    | 09/12        | GRH            |  |
|           |      |  | Standards  |              | EB             |  |
|           |      |  | Approved   | 09/12        | AdH            |  |
|           |      |  |            |              |                |  |
|           |      |  | Scale      | not to scale | Title          | CF-M8, cubeOTO fuse insulation nut, M8 |
|           |      |  | Projection |              | Drawing type   | schematic                              |
|           |      |  |            |              | Drawing number | CF-M8 drawing 1                        |
|           |      |  |            |              | Sheet          | 1 of 1                                 |
|           |      |  |            |              | Layers / Sheet | 01 2 6 9 11 Sheet 01                   |